

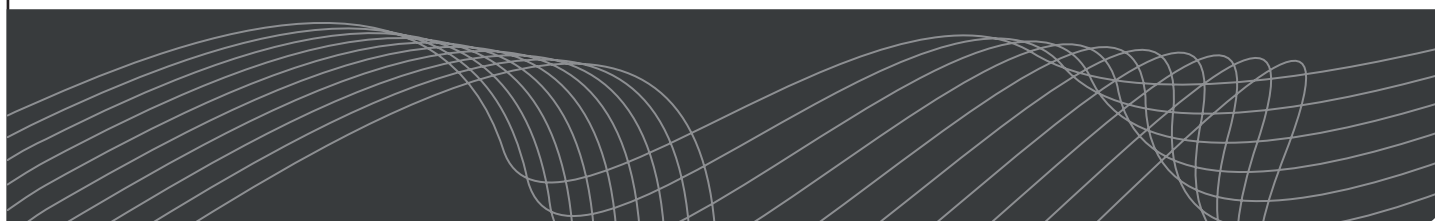

SEBO BALANCE A1

Type: SEVBA25

# INSTRUCTION MANUAL

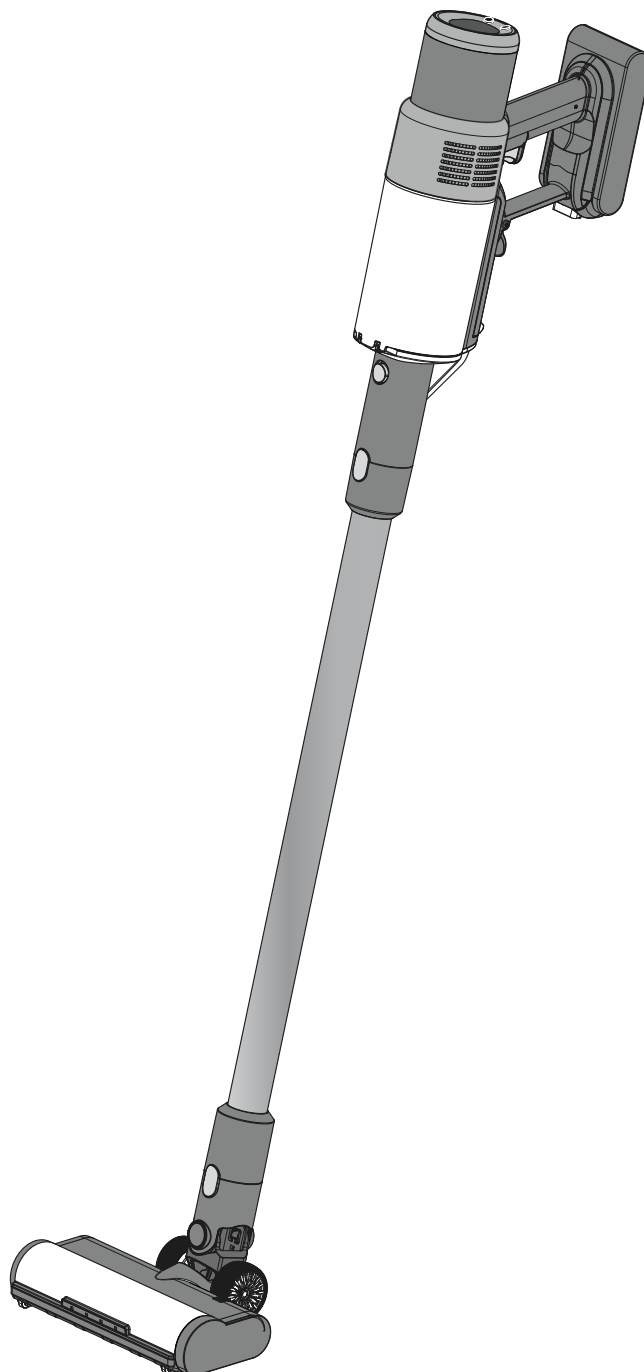

# Table of Contents

	Page
Important Safety Instructions.....	3
Notes on Disposal.....	4
Box Contents.....	5
Service Parts.....	5
Components and Accessories .....	6
Assembly.....	7
Display and Power Controls .....	7
Battery Care.....	8
Charging.....	9
Operation .....	9
Maintenance - Suction Unit .....	10
Maintenance - Power Heads .....	12
Wall Mount .....	13
Assembling the SEBO Station B.A1 .....	13
Trouble shooting and Support .....	14
Technical Data.....	14
Warranty.....	15

## Symbols used in this manual:

1,2,3,....	Item numbers with reference in text and listings
Ⓐ, Ⓑ, ...	Order of operating steps
⚠	Safety related advice. Non-compliance may result in injury or serious damage
!	Instructions for maintaining the functionality of the appliance.

**Before using this vacuum cleaner, please read carefully all safety instructions:  
Non-compliance may result in injury or serious damage.**



**For video instructions on assembly and use, please use the above QR code.**

 **Please read these instructions carefully before using the machine and save them for future reference.**



**PLEASE FULLY CHARGE THE BATTERY BEFORE FIRST USE!**

 **CAUTION!** Failure to follow the safety instructions marked with this symbol can pose a hazard.

Thank you for choosing SEBO. Your new SEBO is a high-quality product that has been developed with the SEBO design team and produced using the most modern technology. Its innovative design makes it easy to use, easy to maintain and highly effective.

To ensure you get the most from your SEBO vacuum cleaner, please take time to read these instructions. We value your feedback and if you have any suggestions, please contact us at [www.sebo.co.uk](http://www.sebo.co.uk).

## **Safety Instructions**

Please save these instructions. If you pass this vacuum to a third party, please pass these on as well. The use of the vacuum cleaner is at your own risk. The manufacturer/ supplier is not liable for any injury or damage caused by incorrect usage of the vacuum cleaner.

## **Intended Use**

This appliance is designed for cleaning domestic households only. This appliance can be used by children aged from 8 years and above and persons with reduced physical, sensory, or mental capabilities or lack of experience and knowledge if they are given supervision or instruction concerning use of the appliance in a safe way and understand the hazards involved. Children should not play with the appliance. Cleaning and user maintenance should not be done by children without strict supervision.

**Children and pets must be strictly supervised during use of this appliance.**

 This vacuum cleaner must not be used for picking up liquid, sharp objects, hot material, such as fire ash, or hazardous/ harmful materials and gases.

Do not use in the presence of flammable, explosive or harmful materials and gases.

Please do not touch the brush roller when battery is installed or vacuum cleaner is working as this can cause a risk of injury to the fingers.

Before using the vacuum cleaner, always check for any signs of damage, especially to all the electrical components.

If a component is damaged, it must be replaced with a genuine SEBO part. For safety reasons this must be done by a SEBO service representative or an authorised service technician.

Do not use or connect damaged devices.

 Always turn off the vacuum cleaner and remove battery before undertaking any maintenance.

 Take care not to run over cables on the floor.

## **Safe use**

Ensure that the connection data on the data label of the charger (voltage and frequency) matches your mains electricity supply.

Always use the handle when operating the vacuum cleaner.

Always stand the machine on a stable surface.

When not in use, always turn off and ensure the rotating brush has stopped.

 **Use on dry surfaces only. Do not store or use outdoors, or in damp conditions. Do not leave in direct sunlight.**

Do not use on people or animals.

Electrical appliance: Do not expose to liquid, moisture or heat. Only clean with a dry or slightly damp cloth.

 This vacuum cleaner should only be operated with genuine SEBO filters and replacement parts. The use of non-genuine parts will waive the warranty for this product and could pose a serious safety risk.

Repairs should be performed exclusively by a SEBO service representative or an authorised SEBO service technician.

 The SEBO BALANCE A1 uses interchangeable, rechargeable Lithium-Ion batteries. It may only be operated with original specification SEBO batteries, AKKU A1 (P/N 95020SE). One is included in the starter kit.

 To charge the SEBO battery, AKKU A1, only use a SEBO BALANCE A1 Charger 95021GB. For further details, please refer to Page 9.

 The use of non-rechargeable batteries in your SEBO BALANCE A1 is not permitted!

#### Notes on Disposal

 Waste electrical equipment (including batteries of any kind) should be disposed of through the correct channel.

You can return this appliance to public collection points. In many regions this can be done free of charge.

For more information, contact your local authority.

Rechargeable power sources usually require special treatment for disposal. Please observe the legal regulations applicable to your region and inform yourself about the prescribed procedures locally.

\* Depending on model

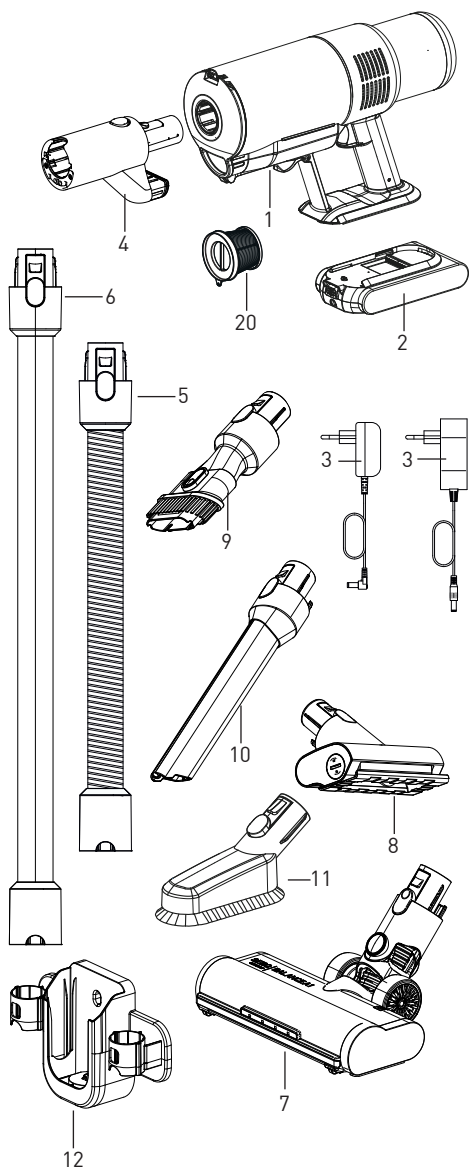

## Box Contents

- 1 95002GB SEBO BALANCE A1 Magenta\*
- 95001GB SEBO BALANCE A1 Blue\*
- 95000GB SEBO BALANCE A1 Grey\*
- 2 95020SE Battery, AKKU A1, 25,9V, 4Ah
- 3 95021GB SEBO BALANCE A1 Charger, 220-240V, UK-plug  
(Sample pictures, included charger may vary)
- 4 Adapter
- 5 8830 Extension Hose\*
- 6 8831 Suction Tube
- 7 95030 SEBO Power Brush
- 8 95031 SEBO Mini Power Brush\*
- 9 8832 2 in 1 Dusting and Upholstery Nozzle
- 10 8862 Crevice nozzle with LED light
- 11 8833 Surface Dusting Brush\*
- 12 8870 Wall Mount
- 20 Motor Protection Filter 1x in Suction Unit, 1x Spare in the box
- 50 8871 SEBO Station B.A1\*, see page 13

Please check, if all listed parts are present.  
If something is missing, please check the packing materials and the poly bag with the documents.

All parts can be assembled and separated without tools.

\* Depending on model

## Service Parts

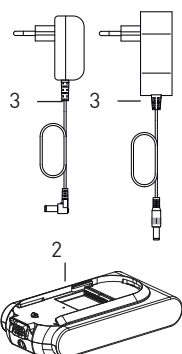
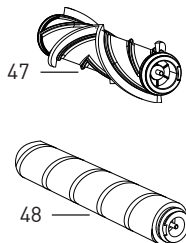
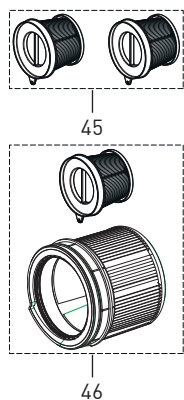

- 45 8850ER 2 x Motor Protection Filter BALANCE
- 46 8851ER Filter Set BALANCE  
1 x Motor Protection Filter and 1 x Micro Hygiene Filter
- 47 8815ER MultiCare - Universal Brush Roller
- 48 8816ER MicroCare - Hard Floor Brush Roller
- 2 95020SE Battery AKKU A1, 25.9V, 4 Ah
- 3 95021GB SEBO BALANCE A1 Charger, 220-240V, UK-plug  
(Sample pictures, included charger may vary)

## Components and Accessories:

### Adapter (4)

The Adapter connects the Suction Unit to the accessories and attachments. It also acts as an additional handle.

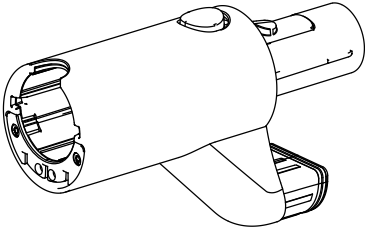

### Extension Hose (5)\*

The Extension Hose attaches to the Adapter. The Crevice Nozzle, Dusting and Upholstery Nozzle and Surface Dusting Brush can be fitted to it for vacuuming hard-to-reach areas. Extendable up to 150 cm.

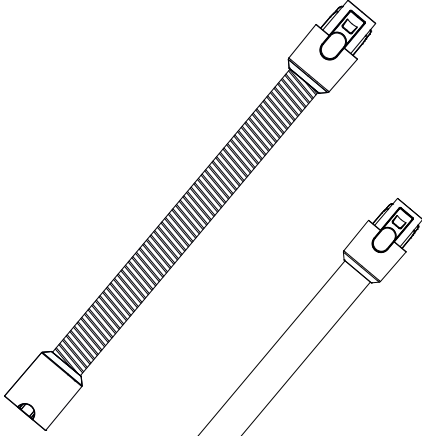

### Suction Tube (6)

The SEBO Power Brush, SEBO Mini Power Brush and the accessories, such as the Crevice Nozzle will fit to the Suction Tube.

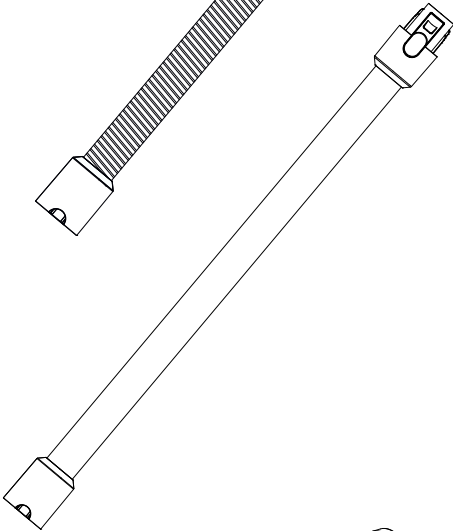

### Dusting and Upholstery Nozzle\* (9)

This two-in-one nozzle can be used as an upholstery nozzle, or by pushing the bristles forward, as a dusting brush.

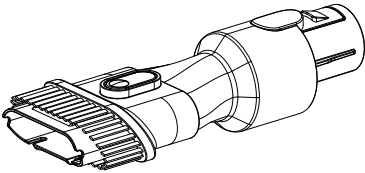

### Crevice Nozzle with LED light (10)

With its integrated LED, the Crevice Nozzle enables precise cleaning in dark, hard-to-reach areas. With its slim shape, it reaches into narrow gaps and ensures thorough cleaning results.

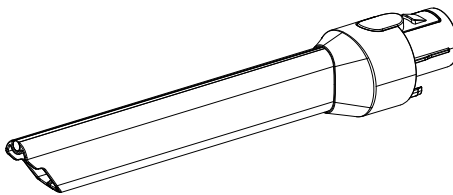

### Surface Dusting Brush\* (11)

The Surface Dusting Brush gently removes dust and debris from smooth surfaces such as wooden stairs and furniture - ideal for thorough and hygienic cleaning.

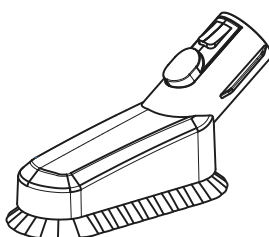

\* Depending on model

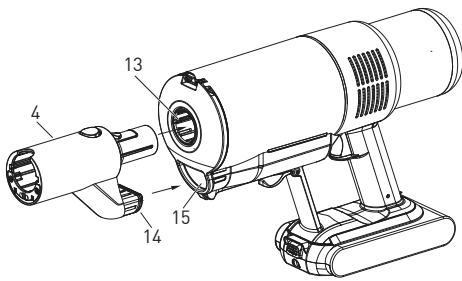

## Assembly:

- Fit the Adapter (4) into the centre (13) of the dust container.
- The air channel (14) needs to connect to the duct under the dust container (15) until it clicks into place.
- All accessories can now be connected directly to the Adapter. This includes the Suction Tube (6), the Extension Hose (5) or one of the nozzles / power heads.

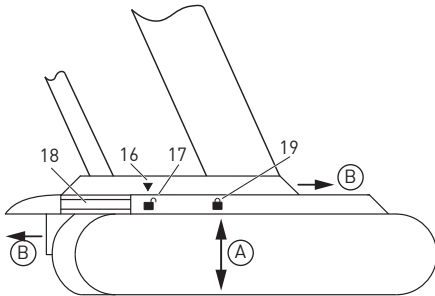
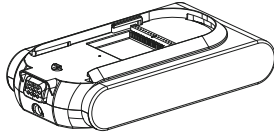

- The battery (43) must be connected to the handle from underneath. Align the arrow (16) on the handle with the open lock symbol (17) on the battery and slide together using the guiding rails (18) until they click together. The arrow will now align with the closed lock (19).

- To separate the machine and battery push the release button (39) on the front of the battery and push the handle forwards/battery backwards. When the arrow (16) and open lock (17) align, the battery can be removed.

**⚠** Never stand a machine without a battery fitted on the base of the handle!

**There is a danger of tipping and the battery contacts may become contaminated or damaged.**

Please place machines without a battery on their side on a flat surface.

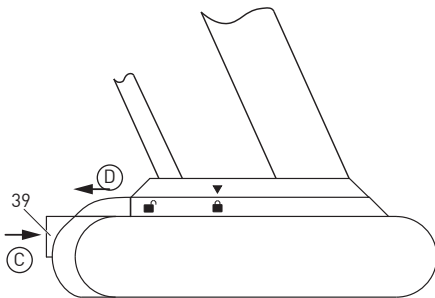

## Display and Power Controls

The battery level display and power control buttons are located at the rear of the Suction Unit.

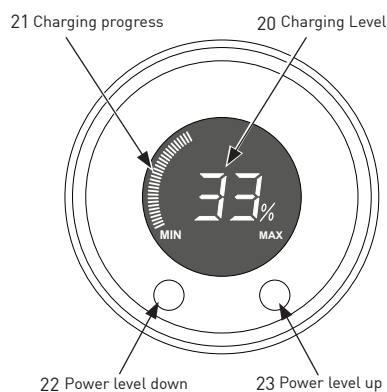

During charging the charge percentage status of the battery is shown numerically in the middle of the display (20), with the bar graph (21) at the edge. The three power levels of the machine can be selected with power down and up buttons (22,23). The chosen power level is shown by the bar graph (21) during operation:

- First third - Power level 1
- First and second third - Power level 2
- All segments - Power level 3

## Battery Care

Rechargeable batteries need special care because damage or incorrect use may have severe consequences.

The following advice should always be followed.

The rechargeable battery needs to be completely charged before first use. It can be charged either connected to the machine or separately.

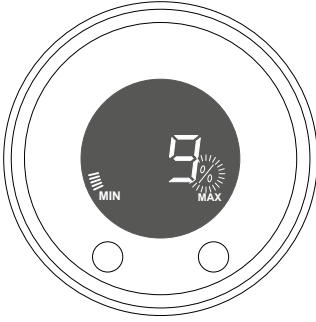

When the charging level of the battery falls below 10%, the percentage symbol flashes to indicate that the battery needs to be charged. Further use should be avoided before recharging, in order not to significantly shorten the service life of the battery.

After the first charge, charging levels between 30% and 80% are ideal.

The charging socket (36) is located on the front of the battery.

Only the original charging device, the SEBO BALANCE A1 Charger (3) or genuine SEBO replacements purchased from authorised SEBO representatives are permitted to charge the battery for this machine.

Charging with non-approved devices can be dangerous. They can damage the battery, cause fire and will void the warranty in any case.

Once the battery is fully charged the charger should be disconnected from the mains/switched off, otherwise the lifetime of the battery may be severely reduced.

Never expose a battery to mechanical stress. Do not drop or dismantle it. Do not expose to heat or leave in direct sunlight.

Please check the battery and machine for irregularities and damage prior to each use.

The connector pins should never be in contact with metallic objects and must not be exposed to any fluids or contamination. Care must be taken not to damage the connector pins on the base of the handle.

 **Damaged or faulty batteries must not be used and must be replaced immediately.**



## Charging

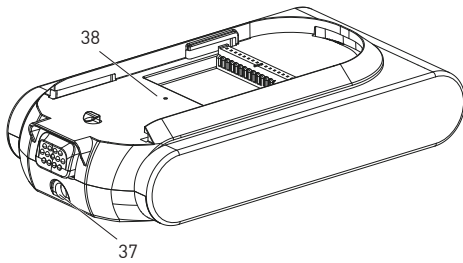

### A) Battery and vacuum separated

Place the battery on a stable and heat proof surface and connect the cable of the charger (3) to the charging socket (37).

Charging is indicated by a flashing, blue LED (38) on top of the battery. The charging process has been completed when this light turns off.

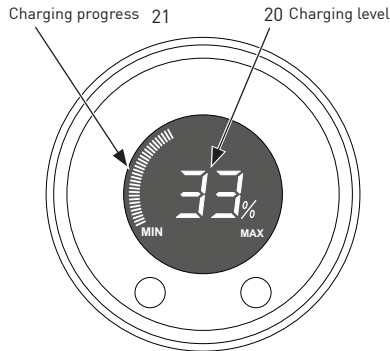

Charging in progress



Charging completed

### B) Battery and vacuum connected

Place the machine on a level and heat proof surface where it will not fall over and connect the charger cable (3) to the charging socket (37).

The display on the back of the machine will show charging status and progress. The bar graph (21) is shown in red and increases continuously with the charging level of the battery. The number (20) in the centre of the display shows the percentage of usable power in plain numbers.

When the battery is fully charged, both the bar graph and the percentage symbol turn green and 100% is displayed.

If this status cannot be gained, even after extended charging, the battery is defective and must be replaced as soon as possible. Please contact SEBO service for assistance. Use only genuine SEBO batteries to avoid the risk of fire.

**⚠** After finishing the charging process the charger should be disconnected from the mains and battery, otherwise the lifetime of the battery may be severely reduced.

**⚠** Mechanically damaged and/or electrically faulty batteries should not be stored and should be recycled as soon as possible (e.g. taken to a recycling centre, or returned to the supplier of the device, etc.). Under unfavourable circumstances, damaged or faulty batteries may have unpredictable reactions, such as fires.

Please see the notes on Page 4.

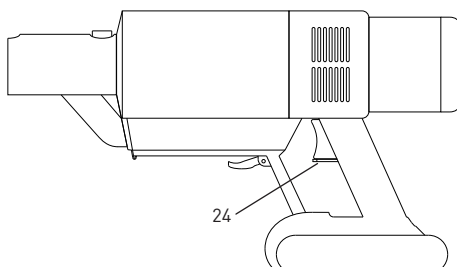
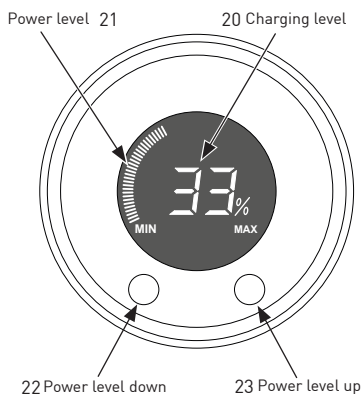

## Operation

Operating the On/Off switch (24) turns the machine on. A short press of the switch (24) is sufficient, you do not need to press it continuously.

The vacuum will start on power level 1. The power level can be adjusted with buttons (22) and (23) at the rear of the machine.

Pressing button (23) turns the power level up and pressing button (22) turns it down.

Each press moves the power to the next level. The bar graph (21) changes accordingly.

If you accidentally turn the machine off it will restart at the last power level used, if the On/Off switch (24) is used again within approx. 10 seconds.

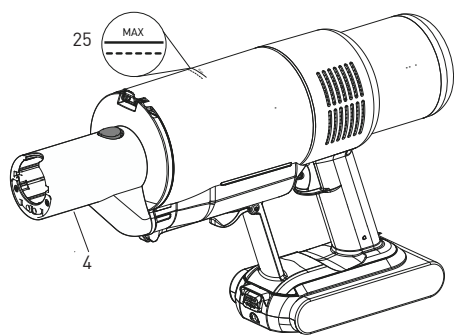

## Maintenance - Suction Unit:

**⚠ Before maintenance or repair the battery must be removed to prevent possible injuries**

The dust container must be emptied when the "MAX" marking (25) is reached, or before.

To empty the dust container, all accessories and the Adapter (4) must be removed.

Have a suitable receptacle, such as a bin, ready to receive the contents of the dust container.

Pulling the lever (27) halfway will release the dust container lid (26). Pulling the lever (27) all the way down will release the whole dust container (28) for more comprehensive cleaning.

**Please note that the lid is spring loaded and will pop up after release.**

If it fails to pop up, press the dust container back onto the Suction Unit to reset the lever mechanism and then pull the lever again.

When releasing the whole dust container, please have a suitable surface underneath, as it falls away from the Suction Unit.

There is a non-return flap (29) in the air duct on the bottom of the dust container. If it is blocked it will obstruct the air path.

Check this flap for free movement every time the dust container is emptied and in the event of poor suction performance. It should move freely when the dust container is shaken back and forth.

### Cleaning the dust container

Once removed from the Suction Unit, the dust container can be cleaned with warm water and mild detergent and then rinsed clean. Please ensure that it is completely dry before use. It must be air dried for at least 24 hours.

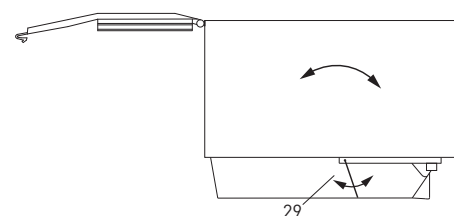
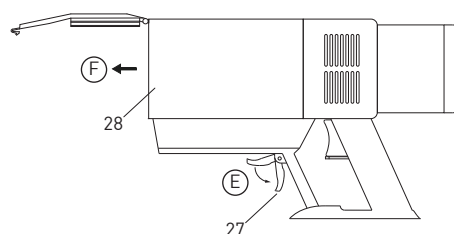
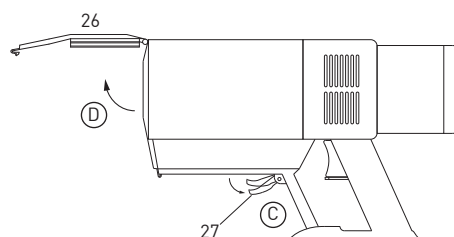
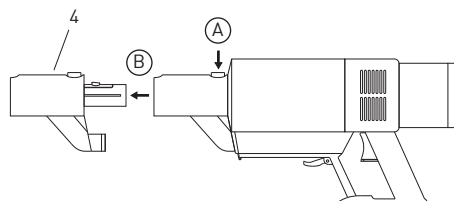

### Removing the cyclone unit

First remove the dust container. Unlock the cyclone unit (30) by gripping the front plastic cone and turning counterclockwise approx. 15° so the arrow (31) aligns with the open lock symbol on the housing above. Take care not to damage the metal foil.

**⚠ The Suction Unit cannot be further dismantled. Any attempts to do so will cause irreversible damage and invalidate the warranty.**

To re-install the cyclone unit, the white arrow (31) should be aligned with the open lock symbol on the machine body and turned clockwise approx. 15° to align with the lock symbol.

### Cleaning the cyclone unit

Once the cyclone unit has been removed it can be cleaned. Use a soft microfibre cloth to clean the outside. Be careful not to damage the metal foil. The six mini cyclones can be blown out with an air compressor, vacuumed out with another vacuum cleaner, or cleaned with pipe cleaners.

The cyclone unit must not be washed as it has electrical connectors.

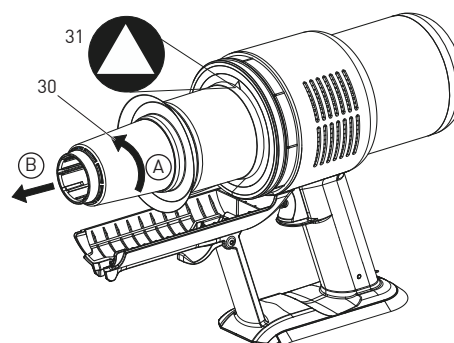

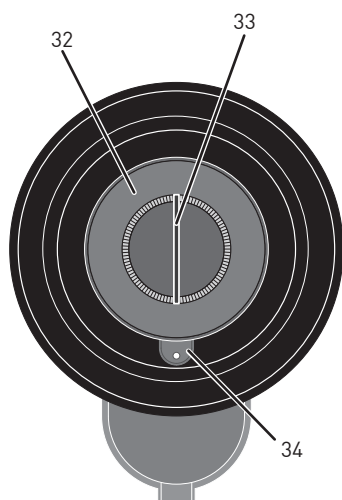

### The Motor Protection Filter

The Motor Protection Filter (32) can simply be pulled out with the handle (33). This filter can be rinsed with clear water but must be completely dry before use. Air dry for at least 24 hours.

We recommend regular replacement to maintain the optimum performance of the appliance.

To install, align the tab (34) of the Motor Protection Filter with the recess in the housing and insert the filter.

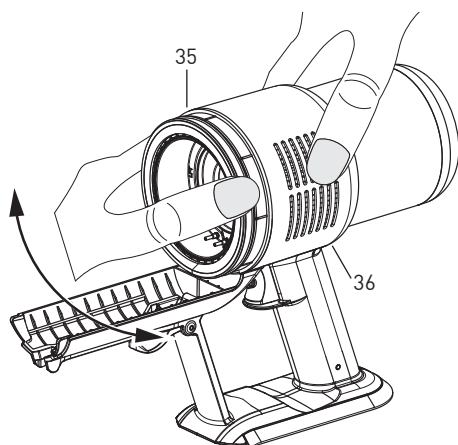

### The Micro Hygiene Filter

The plastic and rubber end of the Micro Hygiene Filter (35) is plugged into the coloured, transparent housing part (36) without any additional locking. To remove, pull the plastic and rubber end away from the coloured transparent housing (36). The whole filter will then come out. Please note that the airtight seal means it holds in place quite firmly.

! This filter cannot be washed and must be replaced.

⚠ The Suction Unit does not have any other parts which a user can maintain or replace.

If a problem occurs and troubleshooting according to the table on page 14 does not lead to a solution, please contact SEBO service for further assistance.

## Maintenance - Power Heads:

### Removal / Replacement of brush roller, SEBO Power Brush

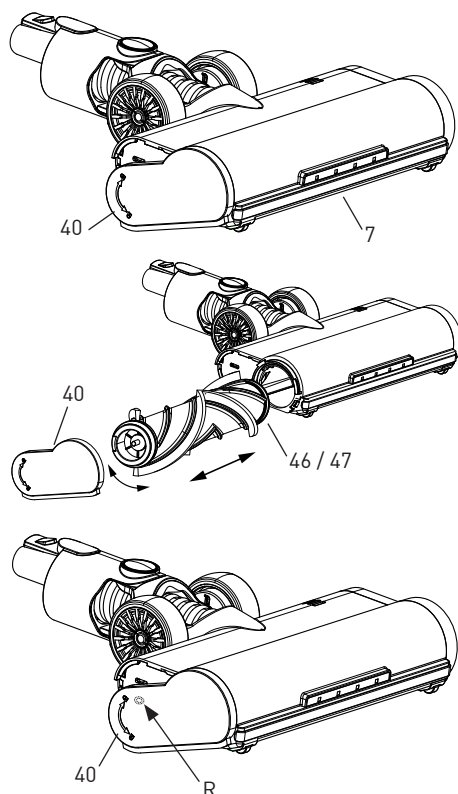

Turn the end cover (40) on the right-hand side of the SEBO Power Brush (7) downwards (counterclockwise) to unlock it.

Take the end cover (40) off and put it to one side. Pull the brush roller (46/47) out of the housing.

Once out of the housing, any threads or hair should be removed.

Both versions of the brush roller can be washed (with end cover removed), but they should be left to air dry standing on one end for at least 24 hours before use.

We recommend replacing them regularly in order to keep performance optimal. Fitting takes place in reverse order:

Insert the brush roller (46/47) and adjust its position by rotating it until the right-hand end aligns with the edge of the housing.

Fit the end cover (40) bearing over the spindle of the brush roller with the rear of the end cover (40) lower than the base of the power brush. Please ensure the end cover frame is flush with the power brush housing and that the locking lug (R) on the housing is within the frame of the end cover.

Turn the rear of the end cover (40) upwards until it clicks into its working position. If the end cover cannot be locked, check the position of the brush roller again and correct its position by turning it.

Your SEBO Power Brush is ready to use.

### Removal / Replacement of brush roller, SEBO Mini Power Brush\*

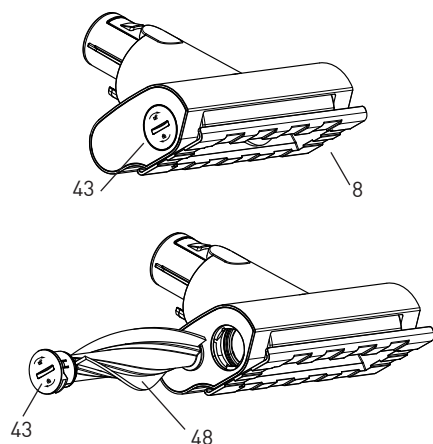

Unlock the right-hand cover (43) with a coin (or something similar) and hold the brush roller bristles to push the brush roller (48) out with the cover attached.

Remove the cover (43) from the brush roller (48) and clean any threads, hair, or dirt.

If necessary, this brush can also be washed (with end cover removed), but it should be left to air dry standing on one end for at least 24 hours before use.

Re-fit the brush roller in reverse order and finally secure the cover by turning it clockwise with a coin to the lock position. If the cover will not fit flush, rotate the brush roller a little.

\* Depending on model

## Wall Mount

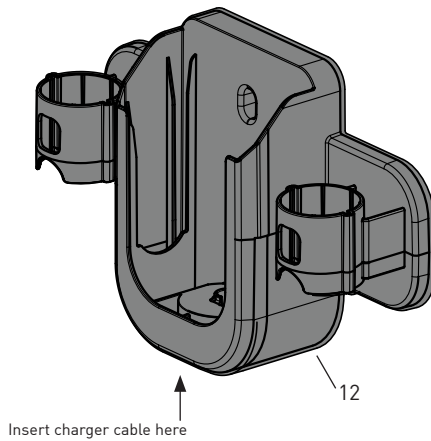

Your new SEBO vacuum comes with a Wall Mount (12), 2 wall plugs and matching screws.

The Wall Mount should be installed in a cool dry place. It should be fitted to a wall at or above 100 cm in order for the assembled vacuum cleaner to hang conveniently.

The Charger plug fits to the Wall Mount so that the machine will charge when placed into it. On either side of the Wall Mount are holders for the Crevice Nozzle and the Dusting and Upholstery Nozzle.

## Assembling the SEBO Station B.A1 (50)

Some models come with the floor stand SEBO Station B.A1 (50) for housing the machine and all its accessories, which requires assembly.

The base (52), the two-piece support tube (51), its connector (53) and the Wall Mount (12) can simply be plugged together and secured with two screws. Please ensure the U-shaped cutout in one of the tube sections is placed at the top so it can connect to the Wall Mount

The Wall Mount (12) has storage points for the Crevice Nozzle and the Dusting and Upholstery Nozzle.

The SEBO Power Brush (7), Adapter (4) and the Suction Tube (6) should stay connected to the Suction Unit. A brush roller (46/47), SEBO Mini Power Brush (8), and the Surface Dusting Brush (11) can be stored on the base together with the Extension Hose (5).

The connector (53) has a support clamp to hold the Suction Tube safely without the Suction Unit fitted.

Please install SEBO Station B.A1 near to a mains outlet so that battery charging will be possible when a vacuum cleaner is fitted.

The charging cable (3) has to be plugged into the lower left part of the Wall Mount. As soon as the battery is placed in the holder charging will start. When the machine indicates the charging process is finished (display coloured green) the charger should be turned off.

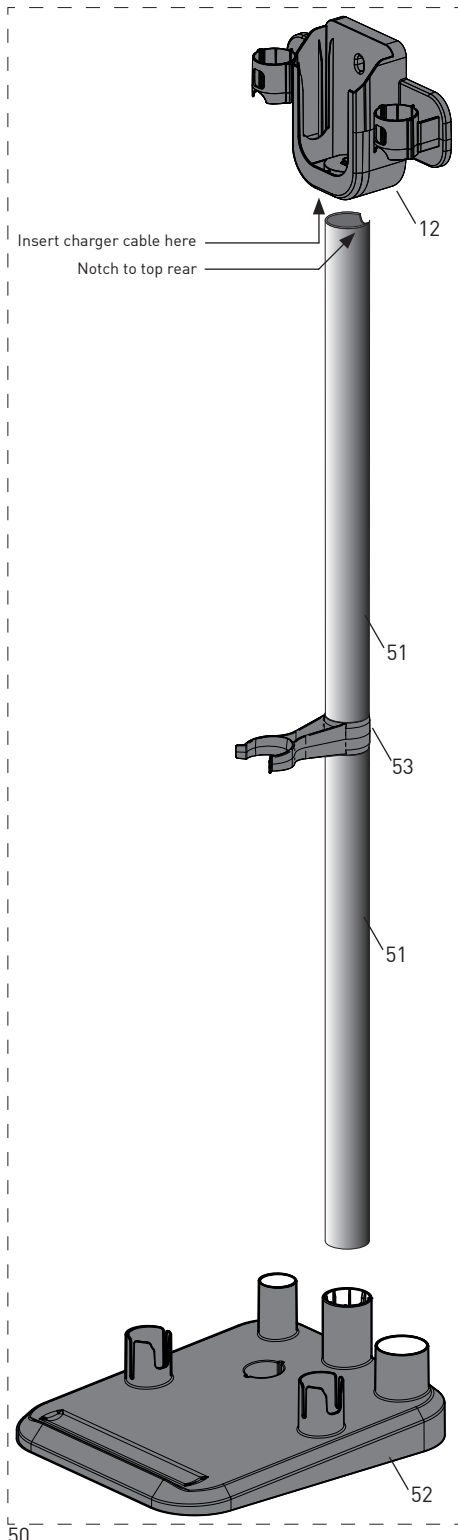

## Trouble Shooting and Support

Description		Possible cause	Proposed solution	See page
Vacuum cleaner does not work		Battery not connected correctly	Remove battery and attach again	7
		Not enough battery charge	Fully charge battery before use	9
		Device was shut off automatically due to high battery temperature	Restart after the machine has cooled down	10
		Clog in the air path	Remove debris from air duct	10
Poor suction		Dust container is full or the filters are clogged with fine dust	Clean the dust container and clean or replace filter set	10/11
		Clog in accessory	Clean out power brushes or accessories	12
Unusual motor sounds		The main air path is clogged	Check the air path from the Power Brush, through the Suction Tube, the Adapter and filters.	10-12
Charging required		Deep discharge protection indicator: Flashing percent symbol	Please charge the battery Switches off after connecting to charger	9
Clog in air path		Motor protection activated	Check the air path from the Power Brush, through the Suction Tube, the Adapter and filters.	10-12
Brush motor switches off		Motor protection activated	Clean power head and brush roller	12
Display, machine switching off.	E1	Low Operating voltage	Recharge battery completely before further use	9
	E2	Brush roller blocked	Check brush roller for foreign material and remove	12
	E3	Dust container full / Filters clogged	Check the air path from the Power Brush, through the Suction Tube, the Adapter and filters.	10-12
	E4	Motor Protection Filter missing	Replace or install the Motor Protection Filter	11
	E5	Electrical malfunction of the power head	Contact SEB0 service for support	
	E6	Electrical malfunction of the Suction Unit	Contact SEB0 service for support	
	E7	Battery not charged	Contact SEB0 service for support	
	E8	High temperature protection active	Contact SEB0 service for support	
	E9	Suction Unit motor current too high	Contact SEB0 service for support	

## Technical Data

		BALANCE A1
Electrical Connection		
	Units	
Nominal voltage battery AKKU A1	V DC	25,9
Isolation class	III	Protective low voltage
Technical data		
Dust container volume	l	0,38
Measures and weights		
Typical working weight	kg	2,3
Length	mm	410
Width	mm	100
Height	mm	225
We reserve the right to make technical changes without notice		

## Warranty

Subject to the terms and conditions below, SEBO (UK) Ltd guarantee BALANCE cordless vacuum cleaners against manufacturing defects for a period of 2 year for parts and labour. It becomes effective ONLY when the registration is completed within 30 days of purchase. Please go to [www.sebo.co.uk](http://www.sebo.co.uk) to register your warranty.

### TERMS & CONDITIONS OF WARRANTY

Before any work can take place, you must supply the machine's serial number and the date and place of purchase. Please keep the proof of purchase receipt and a record of the serial number in a safe place to ensure warranty cover. Work may be chargeable without proof of purchase. This warranty applies to new SEBO machines bought from authorised SEBO UK Ltd retailers only.

All work must be undertaken or authorised by SEBO (UK) Ltd. Unauthorised work involving the removal of any screws will invalidate the warranty.

The machine must be maintained as per its operating instructions.

Any parts replaced will become the property of SEBO (UK) Ltd.

The warranty applies to the UK mainland only\*.

The warranty only covers domestic household use in accordance with the operating instructions.

The use of non-genuine SEBO parts, including (but not limited to) batteries, filters and spares can be harmful to the machine and the use of such parts will invalidate the warranty.

The warranty commences from the date of purchase.

The SEBO warranty is non-transferable.

SEBO reserve the right to charge a fee if the disposal of a machine is required.

### THE WARRANTY DOES NOT COVER

Machines which have not been assembled, used, or maintained in accordance with the operating instructions.

Wear and tear, accidental damage, misuse, neglect, improper maintenance or any machine which has had the serial number altered, defaced or removed.

Reduced battery run times.

Consumable items, including (but not limited to), filters and brush rollers, hoses (excluding electrical hoses), tubes or attachments.

Normal maintenance, servicing or the clearing of blockages. Blockage clearing will incur a service charge if carried out by SEBO.

Damage caused by external sources such as transit, weather, or proximity to heat, e.g. fires, ovens, radiators, direct sunlight etc.

Damage caused by liquid intake, builders' material or hot material such as ash.

Damage caused by unauthorised work.

Damage caused by the use of carpet cleaners/fresheners or chemicals not sold by SEBO.

SEBO (UK) Ltd will not accept liability for any consequential loss or damage whatsoever arising from, or in connection with, this machine.

\*For Eire & Non-Mainland United Kingdom, the domestic use warranty period is 1 years for parts and labour.

This warranty provides benefits which are additional to and do not affect your statutory legal rights.



**SEBO** Stein & Co. GmbH, Wülfrather Straße 47-49, 42553 Velbert, Germany  
Telefon +49(0) 20 53 / 89 81, Telefax +49(0) 20 53 / 89 85, [www.sebo.de](http://www.sebo.de)

© 2025 SEBO Stein & Co. GmbH © Eingetragenes Warenzeichen Technische Änderungen vorbehalten

**SEBO** (UK) Ltd - The Merlin Centre  
Cressex Business Park, High Wycombe, Bucks HP12 3QL.  
Phone: 0 14 94 - 46 55 33, Fax: 0 14 94 - 46 10 44, [www.sebo.co.uk](http://www.sebo.co.uk)  
©2025 SEBO Stein&Co. GmbH ©Registered Trademark. Subject to change.